

**CITY OF CATOOSA, OKLAHOMA
PUBLIC NOTICE OF A CITY COUNCIL MEETING**

.....

TYPE OF MEETING: Regular
DAY: **Monday**
DATE: September 11, 2023
TIME: **6:00 p.m.**
PLACE: City Hall, Council Chambers
214 South Cherokee
Catoosa, Oklahoma 74015

AGENDA

I: Meeting Convened:

- A. Call to Order**
- B. Invocation-Pastor Matt Garwick, Apostolic Worship Center**
- C. Pledge of Allegiance**
- D. Roll Call**
- E. Public Comments:** This is a 15-minute period for comments from the General Public on City-related Non-Agenda Items. (Limited to 3-minutes per speaker)

II: Consent Agenda:

Information: Consideration and appropriate action relating to a request for City Council approval of the Consent Agenda:

- 1) Approval of Minutes of the **August 28, 2023**, Regular Meeting
- 2) Approval of Regular and Prepaid Claims

III: Items Removed From Consent Agenda:

Information: Discussion, consideration and possible action relating to items removed from the Consent Agenda.

IV: Agenda Items:

Item #1: Ordinance No. 2023-394-Z

Information: Public hearing on the application of Case Ventures, LLC to change the zoning of certain real property generally located behind and to the North of the existing Catoosa Post Office and more fully described on Exhibit “A” attached to this agenda for the purpose of a residential multifamily development; followed by discussion, consideration, and possible action to approve Ordinance No. 2023-394-Z, an ordinance rezoning said real property from General Commercial District (CG) to Residential Multifamily Low-Density District (RM-1), directing the Catoosa Planning Commission to change the zoning map of the City of Catoosa to reflect said change, repealing conflicting ordinances, and containing other provisions related thereto. **(Terry Whiteley, Building Official) (Enclosure)**

Item #2: Emergency Clause for Ordinance No. 2023-394-Z

Information: Discussion, consideration, and possible action to approve an emergency clause for Ordinance No. 2023-394-Z. **(Terry Whiteley, Building Official)**

Item #3: Pay Request No. 14 Hamby-Lynch Public Safety Complex Design

Information: Discussion, consideration, and possible action to approve Pay Request No. 14 from GH2 Architects, LLC for the Hamby-Lynch Public Safety Complex design in the amount of \$18,498.68. **(John Blish, City Manager) (Enclosure)**

Item #4: Independent Contractor Agreement with Kellogg Engineering, Inc.

Information: Discussion, consideration, and possible action to approve an agreement with Kellogg Engineering, Inc. for engineering services. **(John Blish, City Manager) (Enclosure)**

Item #5: Disaster Assistance Agreement for Emergency and Major Disasters with the State of Oklahoma

Information: Discussion, consideration and possible action to approve entering into a Disaster Assistance Agreement for Emergency and Major Disasters with the State of Oklahoma to provide financial assistance to the City for damages resulting from severe storms, straight-line winds and tornados during the time period June 14 – 18, 2023; designate Denus Benton and Vicky Sutton as the City’s designee to act on behalf of the City in connection with the agreement; and authorize the City Manager, John Blish to sign the agreement and all other necessary documents on behalf of the City. **(John Blish, City Manager) (Enclosure)**

Item #6: Grant Agreement with Oklahoma Highway Safety Office

Information: Discussion, consideration, and possible action to approve a General Police Traffic Services grant with the Oklahoma Highway Safety Office in the amount awarded of \$44,944.00 for a one-year term beginning October 1, 2023 thru September 30, 2024 and authorize the City Manager, John Blish to sign the agreement and all other necessary documents on behalf of the City. **(Ronnie Benight, Police Chief) (Enclosure)**

Item #7: Approval of aptegy Social Media Webpage and Mobile App

Information: Discussion, consideration, and possible action to approve migrating the cities current social media webpage from Civic Plus to aptegy to include mobile app and interface pending contract approval by the city attorney not to exceed \$13,400.00 with current renewal not to exceed \$6,700.00 starting in October 2024. (**John Blish, City Manager**) (Enclosure)

V: New Business: Any matter not known about, or which could not have been reasonably foreseen prior to the time of posting the agenda.

VI: City Manager Report:

VII: Council Comments:

VIII: Adjourn:

This agenda was filed in the office of the City Clerk and posted **September 8, 2023 by 6:00 p.m.** on the bulletin board located on the North side of the Catoosa City Hall building, 214 South Cherokee, Catoosa, Oklahoma 74015, and on the City's website at: www.cityofcatoosa.org/agendacenter.

Vicky Sutton, City Clerk

EXHIBIT "A"

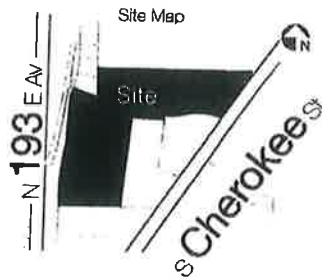

A tract of land that is part of U.S. Government Lot 2 and part of the W2 of the SE/4 of the NW/4 in Section 31, Township 20 North, Range 15 East of the I.B.&M., Rogers County, Oklahoma, according to the U.S. Government Survey thereof, said tract of land being more particularly described as follows, to-wit: Commencing at a point that is the NW Corner of said Section 31; thence S 01°12'31" E along the Wly line of Section 31 for 2504.54 feet; thence N 88°47'29" E for 223.00 feet to the Point of Beginning of said tract of land, said point being on the Ely Right-of-Way line of State Highway 167; thence N 01°12'31" W along said Right-of-Way line and along the Ely line of the tract described in Warranty Deed recorded in Book 428 Page 486 and being parallel with the Wly line of Section 31 for 208.00 feet; thence N 05°02'04" E along the Right-of-Way line for 319.09 feet to a point, said point being on the Sly line of Lot 19 of A Resubdivision of Lots 1, 2, 7, 8, 9, 10, 11, 12 and 17, Block 1, Lot 1, Block 2 and Lots 1 & 2, Block 3 Indian Hills Terrace Addition, Rogers County, Oklahoma, according to the recorded plat thereof; thence N 88°55'11" E along the Sly line of Lots 19 & 20 of said Resubdivision of Indian Hills Addition for 238.85 feet to the SE Corner of said Lot 20; thence N 01°15'39" W along the Ely lines of Lots 20 and 1 of the Resubdivisions of Indian Hills Terrace Addition and along the Ely line of Block 1 of Indian Hills Terrace Addition, an addition to Rogers County, Oklahoma, for 660.82 feet to a point on the Nly line of said Government Lot 2; thence N 88°49'12" E along said Nly line and along the Nly line of said W2 of the SE/4 of the NW/4 for 1,302.67 feet to a point, said point being the NE corner of the W2 of the SE/4 of the NW/4, thence S 01°34'11" E along the Ely line of the W2 of the SE/4 of the NW/4 for 99.04 feet to a point on the Wly Right-of-Way line of U.S. Highway No. 66; thence S 33°17'16" W along said Wly Right-of-Way line for 451.31 feet to a point, said point being the Nely corner of a tract described in Warranty Deed recorded in Book 805 Page 917; thence Nwly and Wly along the Nly line of said tract on a non-tangent curve to the left with a central angle of 46°39'04" and a radius of 298.26 feet for 242.85 feet having a chord bearing of N 80°07'59" W for a chord length of 236.20 feet to a point of tangency; thence S 76°32'29" W along said Nly line and said tangency for 86.34 feet to a point of curve; thence Swly and Wly along the Nly line on a curve to the right with a central angle of 18°34'45" and a radius of 500.00 feet for 162.13 feet having a chord bearing of S 85°49'52" for a chord length of 161.42 feet to a point of reverse curve, said point also being the Nely corner of a tract described in General Warranty Deed recorded in Book 740 Page 656; thence Wly along a curve to the left with a central angle of 6°19'45" and a radius of 500.00 feet for 55.23 feet having a chord bearing of N 88°02'39" W with a chord length of 212.51 feet to a point of tangency; thence S 88°47'29" W along said tangency and said Nly line for 7.35 feet to a point of curve; thence Wly along the Nly line on a curve to the right with a central angle of 7°33'32" and a radius of 1612.01 feet for 212.67 feet having a chord bearing of 87°25'39" for a chord length of 212.51 feet to a point, said point being the NW corner of the tract described in said Book 740 Page 656; thence S 03°30'01" W along the Wly line of said tract for 752.16 feet to a point that is the SW corner of said tract; thence S 88°47'29" W for 506.99 feet to the Point of Beginning of said tract of land.

AND

A tract of land that is all of Lots 1 and 20 and part of Lots 2 and 19 and part of Marshall Place in a Resubdivision of Lots 1, 2, 7, 8, 9, 10, 11, 12 and 17 Block 1; Lot 1 Block 2 and Lots 1 & 2 Block 3 and Reserve A, INDIAN HILLS TERRACE ADDITION, Rogers County, Oklahoma, according to the recorded Plat thereof, said tract of land being more particularly described as follows, to-wit: Beginning at a point that is the Southeast corner of said Lot 20; thence S 88°55'11" W along the Southerly line of said Lots 20 and 19 for 238.85 feet to a point on the Easterly right of way line of State Highway 167; thence N 05°02'07" E along said right of way line for 414.16 feet to a point, said point being the Northwest corner of said Lot 2; thence S 72°12'01" E along the Northerly lines of said Lots 2 and 1 for 204.64 feet to a point, said point being the Northeast corner of Lot 1; thence S 01°15'39" E along the Easterly line of Lots 1 and 20 for 345.58 feet to the Point of Beginning of said tract of land.